

## P48 GEOMETRY

TUBES MATERIAL	∅	THICKNESS	TYPE	DENOMINATION	CERTIFICATION
Copper	16	0.75 – 1.00 – 1.50	Seamless	Cu-EN 12735-2	EN 10204 3.1 and Factory Standards
Copper nickel 70-30 (90-10)				Astm B111-C71500 (C70600)	
Carbon Steel		1.50 – 1.80		P235 GH EN 10216-2	
Carbon Steel Hot Dip Galvanised		1.50 – 1.80 – 2.60			
Stainless Steel 304L – 316L		1.00 – 1.50	Welded	Astm A249 tp 304L – 316L	
			Seamless	Astm A213 tp 304L – 316L	
Titanium	More information will follow				

FINS MATERIAL	THICKNESS	TYPE
Aluminium (Al)	0.15 – 0.25 – 0.40	Currogated
	<b>1.00</b>	Flat
Aluminium Pre-paint (AlPr)	0.15 – 0.25 – 0.40	Currogated
Aluminium Mg2.5 (AlMg)		
Copper (Cu)	0.20	Flat
Stainless Steel 304 – 316 (Inox)		
Carbon Steel		

Fins spacing (mm)	2.0	2.2	3.5	2.9	3.0	3.2	3.6	4.0	4.5	5.0	5.6	6.0
Fins / mt	500	450	400	350	330	310	280	250	220	200	180	165

NOT AVAILABLE FOR HOT DIP GALVANISED COILS

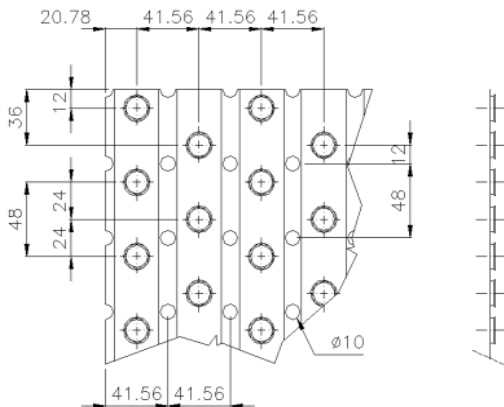

FLAT

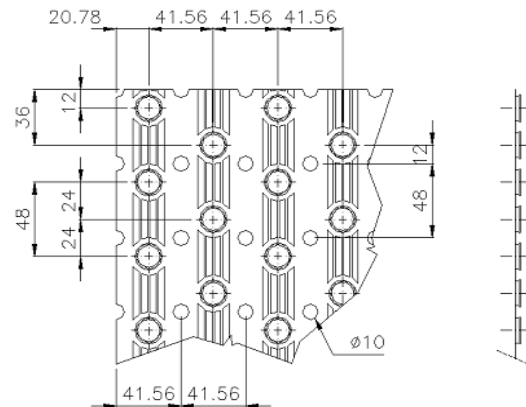

CURROGATED